



PLATE LIFTING CLAMPS



HORIZONTAL CLAMP



Premium Quality



VERTICAL CLAMP



UNIVERSAL CLAMP

- Compact & strong
- Low carbon & heavy duty welded Alloy steel body
- Ergonomically designed handle
- Hinged hook provides enough clamping force
- Strong jaw guarantees full surface contact
- Clamp teeth duly hardened & tempered
- Efficient locking arrangement
- Enhanced durability & dimensional accuracy
- Proof Test - 150% of Working Load Limit
- Solid robustness & long life
- High grade material enhances endurance cycle
- Safe, Simple, Easy & Fast replacement of wear parts
- Stringently inspected against set of parameters



PLATE LIFTING CLAMPS

TECHNICAL PARAMETERS

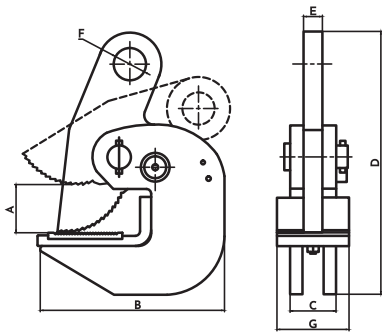

Product Code		KHLC0100	KHLC0200	KHLC0300	KHLC0500	KHLC0800
Capacity	Tonnes	1	2	3	5	8
Test Load	Tonnes	2	4	6	10	16
Jaw Opening	mm	0 - 30	0 - 40	0 - 45	0 - 55	0 - 100
Dimensions	A mm	0 - 30	0 - 40	0 - 45	0 - 55	0 - 100
	B mm	153	172	180	185	320
	C mm	36	44	48	54	60
	D mm	215	245	250	270	480
	E mm	14	18	18	20	25
	F mm	25	25	28	30	42
Weight	Kg	3.5	5	6	7.5	23

Higher sizes are available on request. Due to continual development of products, manufacturer reserve the right to modify design, dimensional parameters and component material without prior notice

TECHNICAL PARAMETERS

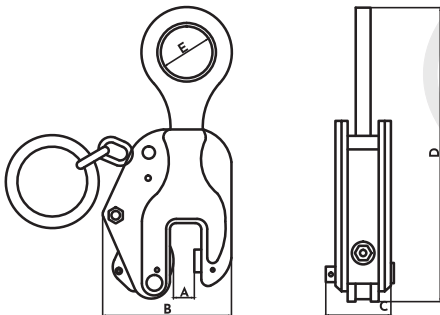

Product Code		KVLC0100	KVLC0200	KVLC0300	KVLC0500	KVLC0800
Capacity	Tonnes	1	2	3	5	8
Test Load	Tonnes	2	4	6	10	16
Jaw Opening	mm	0 - 22	0 - 30	0 - 40	0 - 50	0 - 60
Dimensions	A mm	0 - 22	0 - 30	0 - 40	0 - 50	0 - 60
	B mm	165	154	180	225	265
	C mm	66	72	88	92	105
	D mm	270	315	378	452	450
	E mm	47	58	56.5	65	65
Weight	Kg	3.5	5.39	5.6	7.5	22

Higher sizes are available on request. Due to continual development of products, manufacturer reserve the right to modify design, dimensional parameters and component material without prior notice

TECHNICAL PARAMETERS

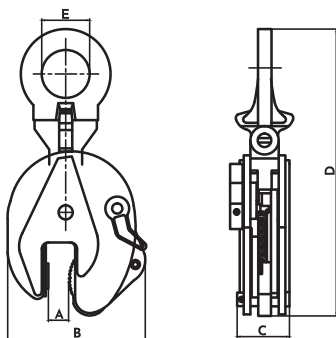

Product Code		KULC0075	KULC0150	KULC0200	KULC0300	KULC0500	KULC0800
Capacity	Tonnes	0.75	1.5	2	3	5	8
Test Load	Tonnes	1.5	3	4	6	10	16
Jaw Opening	mm	0 - 15	0 - 20	0 - 25	0 - 30	0 - 50	40 - 80
Dimensions	A mm	0 - 15	0 - 20	0 - 25	0 - 30	0 - 50	40 - 80
	B mm	114	175	175	212	255	290
	C mm	45	65	66	85	95	115
	D mm	217	350	370	410	480	600
	E mm	27	68	65	58	80	88
Weight	Kg	1.9	7	8.2	13.8	23.3	37

Higher sizes are available on request. Due to continual development of products, manufacturer reserve the right to modify design, dimensional parameters and component material without prior notice