

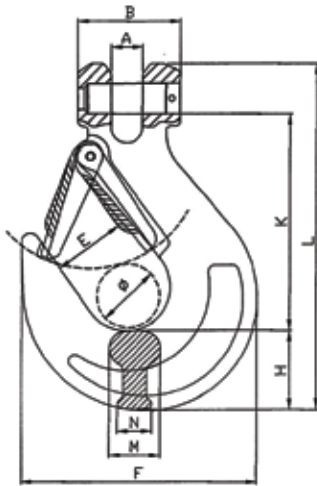

CLEVIS SLING HOOK



TECHNICAL PARAMETERS

Product Code	WLL (Ton)	B.L. (Ton)	A (mm)	B (mm)	C (mm)	H (mm)	L (mm)	K (mm)	E (mm)	F (mm)	N (mm)	M (mm)
8-SLR012-06	1.12	4.48	8±1	31.6±2	20±2	19.8±1	110±3	75.3±2	23.5±2	76.5±2	10±1	14±1
8-SLR012-7/8	2	8	9.5±1	36.6±2	25±2	25±1	128±3	86±2	22±2	84±2	12±1	18±1
8-SLR012-10	3.15	12.6	12.5±1	49.1±2	30±2	31±1	158±3	104±3	30±2	103±2	16±1	23±1
8-SLR012-13	5.3	21.2	16.5±2	56.5±3	35±2	42.5±2	198.3±4	128±3	37.5±3	132±3	15±1	27.5±1
8-SLR012-16	8	32	21.5±2	70.5±3	47.5±3	54±2	234±4	148.3±4	46.5±3	160±3	24±1.5	35±1.5
8-SLR012-20	12.5	50	24±2	77±3	59±3	58±2	274±4	176±4	55±3	185.7±3	32±1.5	42±1.5
8-SLR012-22	15	60	25±2	91±4	64±4	62±2	320±5	213±5	66±4	228±4	36±2	50±2
8-SLR012-26	21.2	84.8	30±2	117±4	78±4	75±3	389±5	251.6±5	85±4	257±4	34±2	60±2
8-SLR012-32	31.5	126	35±2	150±5	100±5	88±3	480±6	317±6	103±5	318±5	42±2	66±2

Higher sizes are available on request. Due to continual development of products, manufacturer reserve the right to modify design, dimensional parameters and component material without prior notice.

CLEVIS SLING HOOK

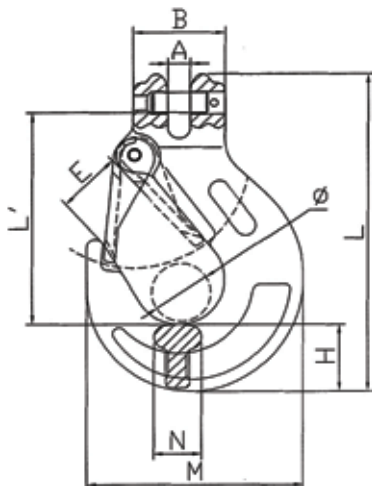

TECHNICAL PARAMETERS

Product Code	WLL (Ton)	B.L. (Ton)	A (mm)	B (mm)	E (mm)	C (mm)	H (mm)	M (mm)	N (mm)	L (mm)	L' (mm)
SLR333-6	1.12	4.48	8±0.5	32±1	20±1.5	17 ⁺¹ ₋₂	20±1	68 ⁺¹ ₋₂	15±1	108±2	73±2
SLR333-7/8	2	8	9.5±0.5	38.5±1	23±1.5	24 ⁺¹ ₋₂	25±1	87 ⁺¹ ₋₂	17±1	129.5±2	87±2
SLR333-10	3.15	12.6	12.5±0.8	48±1	28±1.5	29 ⁺¹ ₋₂	36±1.5	106 ⁺¹ ₋₃	23.5±2	163.5±3	105±3
SLR333-13	5.3	21.2	16±0.8	56±1.5	35±2	36 ⁺¹ ₋₂	41.6±1.5	130 ⁺¹ ₋₃	28±2	196±3	127±3
SLR333-16	8	32	18.5±1	65.5±2	45±2	54 ⁺¹ ₋₂	46±1.5	155.5 ⁺¹ ₋₃	35±2	239±3	157±3
SLR333-20	12.5	50	24.5±1	92±2	51.5±3	66 ⁺¹ ₋₃	51±1.5	180 ⁺¹ ₋₃	42±2	281±4	192±4

Higher sizes are available on request. Due to continual development of products, manufacturer reserve the right to modify design, dimensional parameters and component material without prior notice.